

# BERMUDA



# Pressure Filter

Pond filter and UVC

## Instruction Manual

**IMPORTANT:** Please read this instruction manual carefully before using this product. Keep the manual safe for future reference.

Thank you for purchasing a Bermuda Pressure Filter.

The Bermuda Pressure filter has a compact design that combines mechanical and biological filtration with an in-built 9 Watt Ultra Violet Clarifier for crystal clear water. Being a pressurised unit, water can be pumped uphill out of the unit to feed water courses or return to the pond while the filter remains hidden.

## **Attention**

1. Keep out of reach of children
2. A drip loop should be installed in the power cable of the UV, to prevent water running downwards into an outdoor socket or outdoor switchbox.
3. An RCD (of which the rated working current is not over 30mA) must be installed when using the pump and UV, and the power sockets must be connected to an earth.
4. The Bermuda Pressure Filter is intended for outdoor use only. Although shower proof it must never be placed in the pond.
5. The filter must never be used to filter any flammable liquids, or water over 35°C.
6. Always disconnect the power supply when handling, servicing or maintaining the UV.
7. Do not attempt to unplug or unwire the UV with wet hands.
8. Do not carry or retrieve the Pressure Filter by the electrical cable.
9. Power cable to UV cannot be replaced. If cut too short or in any way damaged, discard the unit. Do not attempt to access the electricals inside.
10. Always install the filter on a flat, level and firm surface.

## Usage

Only suitable for outside garden ponds. UV can be run continuously, 24 hrs / day.

- If using 1¼" or 1½" hose, cut off the smaller diameter step(s) on each of the three supplied hosetails.
- Make sure the clamp ring is secured while the filter is running.
- Always unplug UV before viewing or handling.
- Do not look at UV bulb when lit and plugged in.
- Spend 30 minutes checking for leaks after installing.

## Installation

1. The filter can be installed either above ground or in the ground.
2. Place filter in your desired position
3. Fit supplied hosetails, ensuring that the rubber washers are fitted between filter body and hosetails to prevent leaks.
4. Once hose has been chosen, cut off any narrower steps on the hosetails with a hacksaw.
5. Slide hose over hosetails and fasten with hose clips (not supplied)
6. Unfasten the locking handgrip on the filter body and ensure rubber sealing ring is in place all the way round the filter body. Failure to do this may cause leaks.
7. Ensure return hose returns to pond, and switch on pump. Water should now fill filter body and return to pond via the hose.
8. Switch on UV.

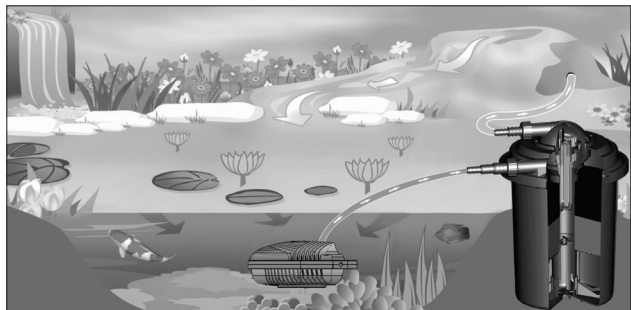

## Filter Cleaning

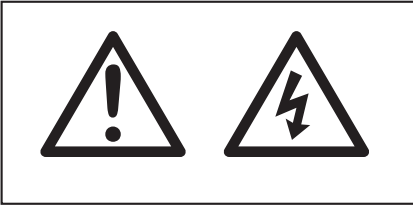

**Step 1** - Ensure the filter and UV are isolated from the mains electricity.



**Step 2** - To access the sponges for inspection or replacement, slide clasp on clamp ring to the right, while at the same time depressing the left hand side of the clasp and pulling to the left. Use two hands.



**Step 3** - Lift the lid and connected sponges out of the filter body and turn upside down



**Step 4** - Remove the bottom shield



**Step 5** - Using a screwdriver (not supplied) undo the screws in the bottom support plate.



**Step 6** - Sponges should be lifted off and cleaned in a bucket of old pond water.



**Step 7** - To clean black Bio Balls in the base of the filter, remove by hand and wash in old pond water, then replace.



**Step 8** - Reverse steps 4 to 9 to ensure the clean Bio Balls and sponges are re-installed correctly and lid is closed.

## UV Maintenance

1. Ensure the filter and UV transformer are isolated from the mains electricity.
2. Unscrew the UV cap.
3. Carefully slide out the UV lamp from the quartz sleeve.
4. Replace with new UV lamp.
5. Re-fit UV cap.
6. Tighten up the UV connector.
7. Connect UV transformer and filter up to mains electricity.

**CAUTION: NEVER LOOK DIRECTLY AT AN ILLUMINATED UV LAMP.**

## Trouble shooting

1. If water is leaking around the hosedetails, check that the supplied rubber washers have been fitted. Check that the hose is the right size for the hosedetail and that the hoseclip has been properly tightened.
2. If water is leaking from the clamp, check that it is done up properly and tight, and that the O-ring is present inside the filter casing.
3. If the water turns green, check that the UV is plugged in and running 24 hours per day. If more than six months old the lamp will need replacing. Check that the quartz sleeve is clean and clear, to allow the UV light to penetrate the water. Check that the pump and filter have been properly matched for the pond size.
4. If there is a substantial loss of flow, it may mean that the sponges are clogged with debris. Open filter body, remove, clean and / or replace sponges with new.
5. If filter sponges do not spring back after cleaning, replace old sponges for new.

## Exploded view - Pressure filter

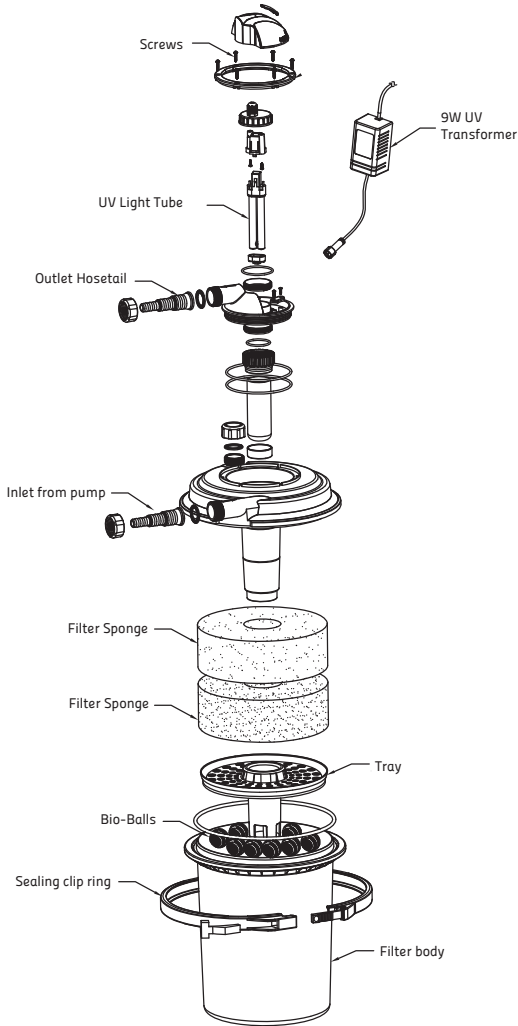

## Specifications

MODEL	BER CODE	MAX. POND VOLUME	RECOMMENDED PUMP	UV POWER
5000	BER0103	5,000 litres / 1,100 gallons	3,500lph / 770gph	18W

## Guarantee

This product is guaranteed against defects in material and workmanship for **one year** from the date of purchase, under normal usage.

The guarantee **DOES NOT APPLY** in case of improper use, negligence, lack of maintenance or accidental damage to the pump. If the pump fails due to a manufacturing fault within this period it will be either repaired or replaced free of charge. Moving parts or wearable parts including the impeller and any washers or O rings, also quartz sleeves and UV bulbs are not covered by the guarantee and are available to order from your Bermuda retailer.

Should your Bermuda product stop working refer first to trouble shooting and if this does not help, return the product to the place of purchase.

Liability is limited to replacement of the faulty product only. No other costs will be reimbursed. This guarantee is not transferable and does not affect your statutory rights.

Do not attempt to tamper with or access electrical components inside the pump body. Doing so will invalidate the warranty.

The manufacturer or supplier shall not be responsible, or held liable for any damages caused by defective components or materials of this product, or for loss incurred by interruption of service, or any consequential/incidental damages and expenses arising from the production, sale use or misuse of this product or any other consequential loss.

Any warranty claim must be accompanied by a valid, dated proof of purchase. Evolution Aqua, Bermuda, its distributors and dealers shall not be held liable for any loss of fish, plants or any other livestock as a result of any failure or defect of this product.

The installation and use of your product outside of our recommendations as printed in this manual may also void the warranty.



**[www.bermudawatergardens.com](http://www.bermudawatergardens.com)**

**BERMUDA** an Evolution Aqua brand.  
Evolution House, Kellet Close, Wigan, Lancashire, WN5 0LP

DISTRIBUTED BY: Certikin, Witan Park, Avenue 2,  
Station Lane Industrial Estate, Witney, Oxfordshire, UK, OX28 4FJ